

REINFORCEMENT FOR STRIKE  
AS REQUIRED, 2 PLACES

RECOMMENDED CUTOUT

#12-24 TAPPED HOLES  
2 PLACES

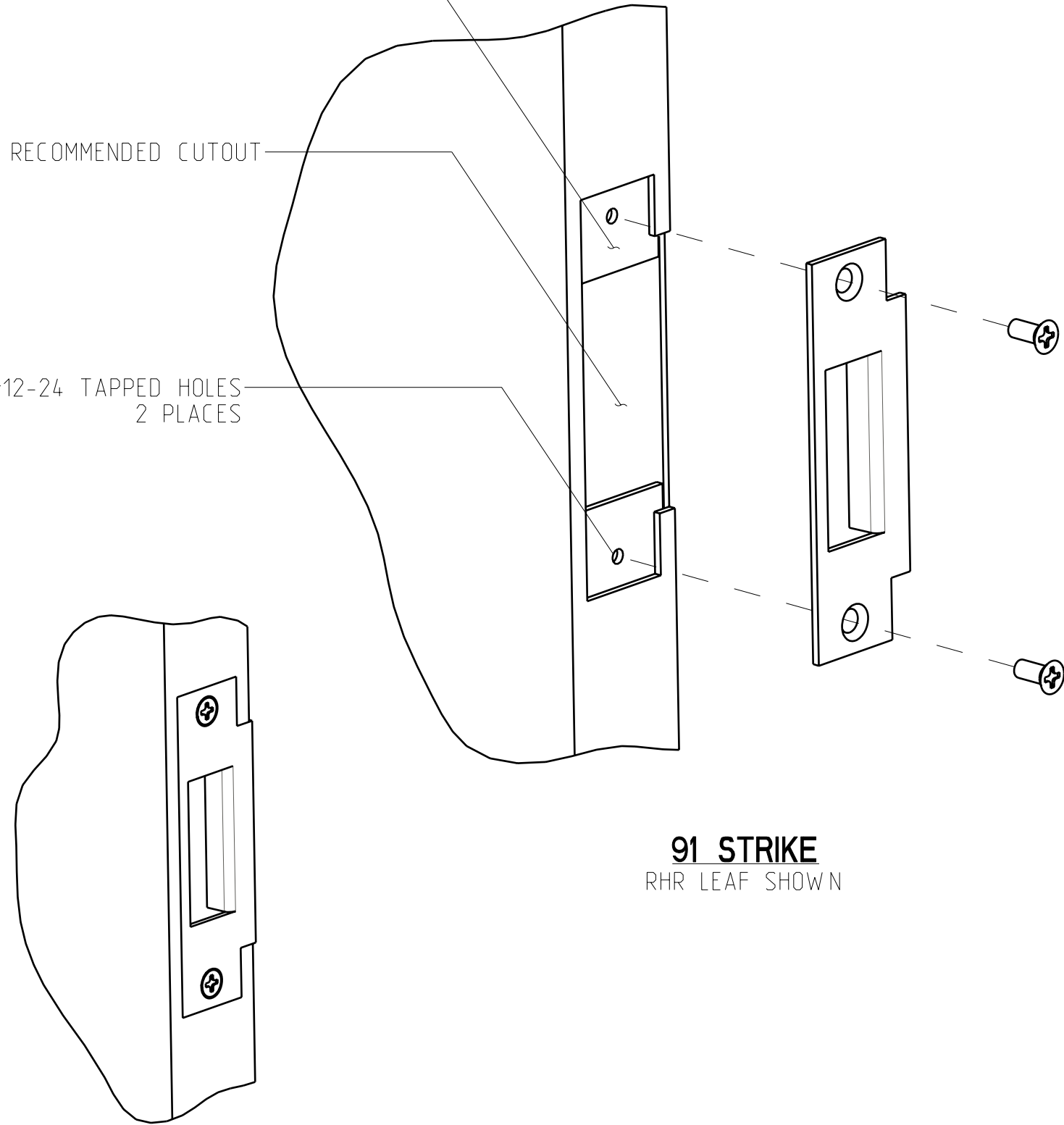

**91 STRIKE**  
RHR LEAF SHOWN

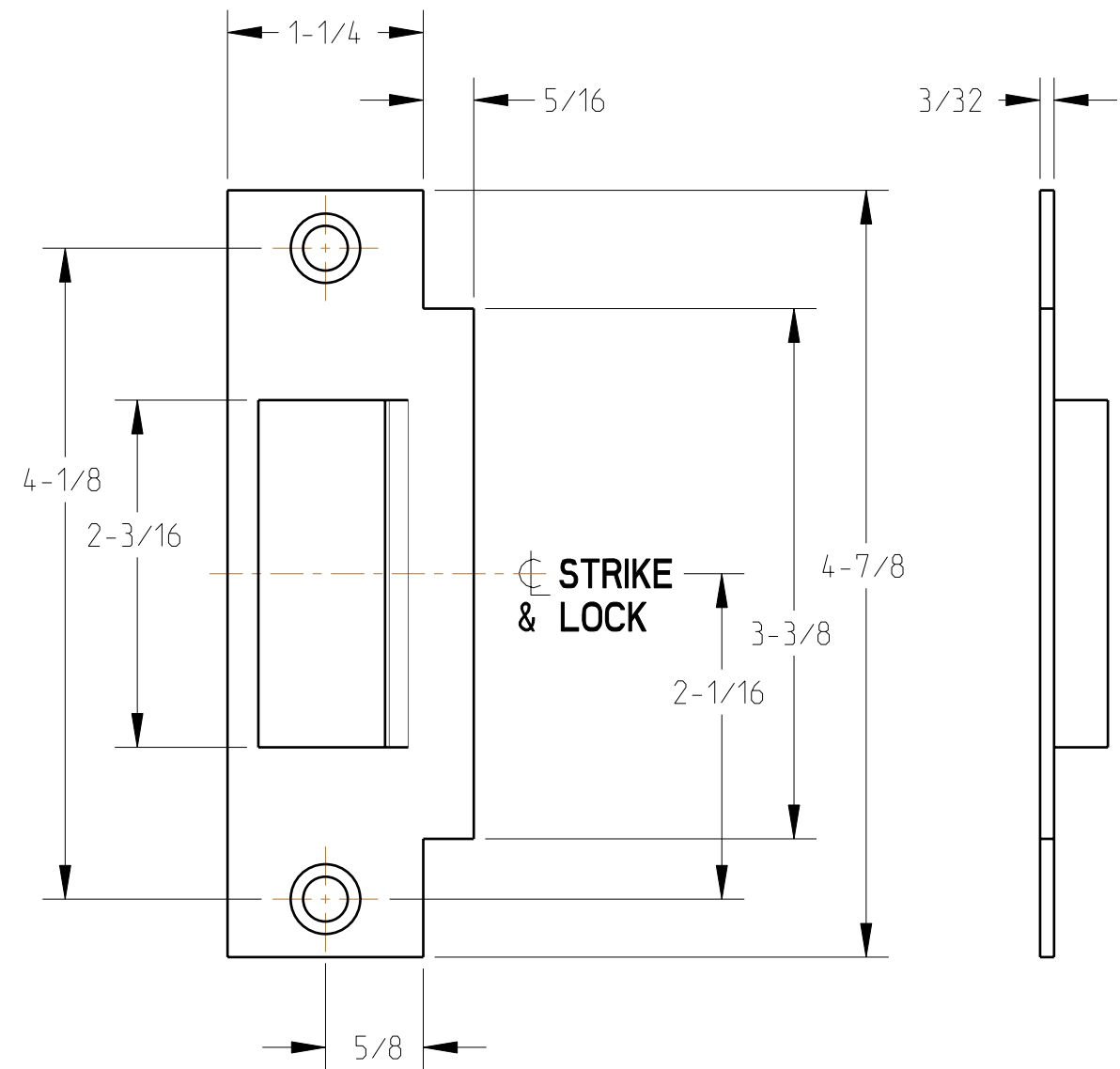

**RESPONSIBILITY**  
Door and Frame Manufacturers are responsible for providing adequate construction or reinforcements for proper installation of hardware shown. All architectural builders hardware must be installed on properly reinforced doors and frames regardless of the type, material, or method of construction.

**91 STRIKE**  
**(DOUBLE DOOR WITH OVERLAPPING ASTRAGAL, ANSI, FLAT LIP)**  
**FOR MORTISE LOCK**

**DETEX**<sup>®</sup>  
CORPORATION

SCALE: 1:1

DATE: 8/29/06

TEMPLATE NO: T2003